

SpEC COVERJOINT

FORMERLY KNOWN AS BCR COVERJOINT

EXTRUDED ANODISED

ALUMINIUM CLIP-IN

JOINT COVERS FOR

FLOOR, WALL, CEILING

AND CORNER

EXPANSION JOINTS

SpEC

A B A R D A W I L I N T E R N A T I O N A L C O M P A N Y

DESCRIPTION

SpEC Coverjoint is a range of extruded aluminium joint cover strips designed for use in internal and external situations where a neat and long lasting finish is required for expansion joints in floors, walls, ceilings, beam/slab soffits and corners.

SpEC Coverjoint is supplied with heavy duty spring clips for easy and secure installation. Weatherproof fixing can be achieved with the aid of a sealant - see INSTALLATION section below.

While the floor profiles are designed for foot traffic, the heavy duty profile C5FL-HD can also be used in areas with light wheeled traffic.

The Wide Joint (WJ) profiles cater for extra wide expansion joints of 50 - 80mm common in larger structures.

TYPICAL USES

- Floor, wall, ceiling and corner joints in residential and commercial buildings such as apartment blocks, housing developments, shopping centers, office blocks, schools, hospitals, airport terminals, bus stations, etc.
- Wall, ceiling and corner joints in industrial and commercial buildings like heavy storage areas, parking garages, workshops, factories, etc. For floor applications in these areas contact SpEC Technical Department.

ADVANTAGES











- Neat, uniform and long-lasting protection with attractive anodised or powder coated finish.
- Suitable for interior and exterior use.
- Quick and simple installation requiring minimal or no preparation.
- Accommodates joint movement while covering irregularities and tolerances.
- Secure and weatherproof fixing - but removable if necessary.
- Full range covering floor, wall, ceiling and corner joints for various joint sizes.

TYPES AND SIZES

SpEC Coverjoint is available in four size groups for joints ranging from 12mm to 80mm wide, with appropriate corner profiles for each size group. Refer to Table 1 below to select the right profiles for your project.

All profiles are supplied in standard lengths of 3m.

Table 1:

SYM	Ref	Joint Size	Location
	C5FL	12-20mm	Floors
	C5FL-HD	12-20mm	Floors, HD
	C5WS	12-20mm	Walls/Soffits
	C35CR	12-20mm	Corners
	C7FL	20-35mm	Floors
	C7WS	20-35mm	Walls/Soffits
	C55CR	20-35mm	Corners
	C90WJ	35-60mm	Floors/Walls/Soffits
	C90CR	35-60mm	Corners
	C120WJ	50-80mm	Floors/Walls/Soffits
	C120CR	50-80mm	Corners

FINISHES

Standard Finish: Silver Anodised (matt finish)
Optional Finishes (subject to minimum quantity):

- Floor : Mill Finish
Wall/Corner : Bronze Anodised and Powder Coated (RAL Pastel Colours)

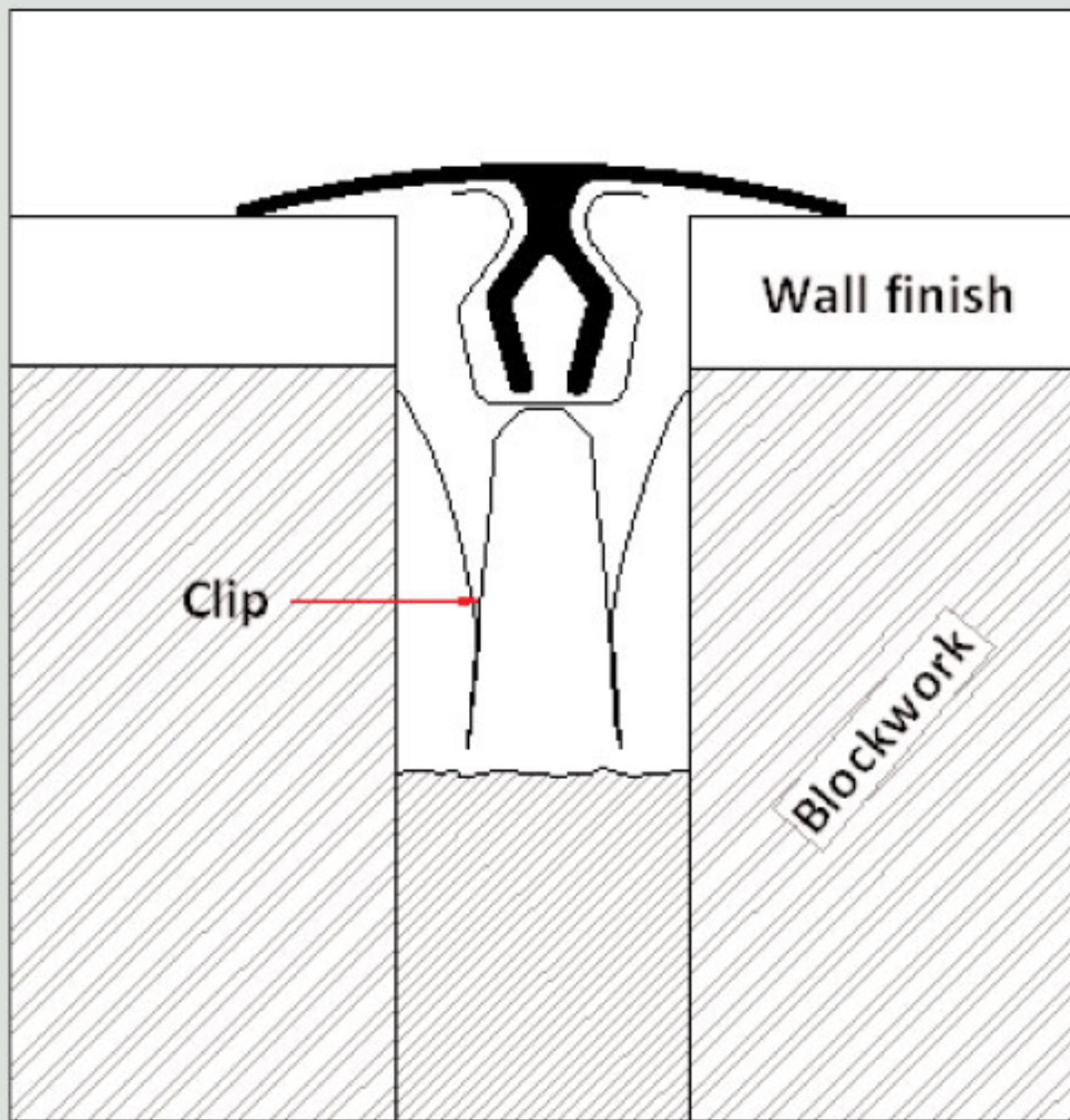

TYPICAL WALL JOINT

CLIPS

Four types of clips are available depending on the joints size, suitable for floor, wall and corner profiles. Correct selection of clips is essential for proper placement and function of the system. See Table 2 below for clip selection.

Table 2:

Clip Type	Joint Size	No. Per 3m Length	
		Floor	Wall/Corner
1	12-20mm	4	3
2	20-35mm	4	3
3	35-60mm	4	3
4	50-80mm	4	3

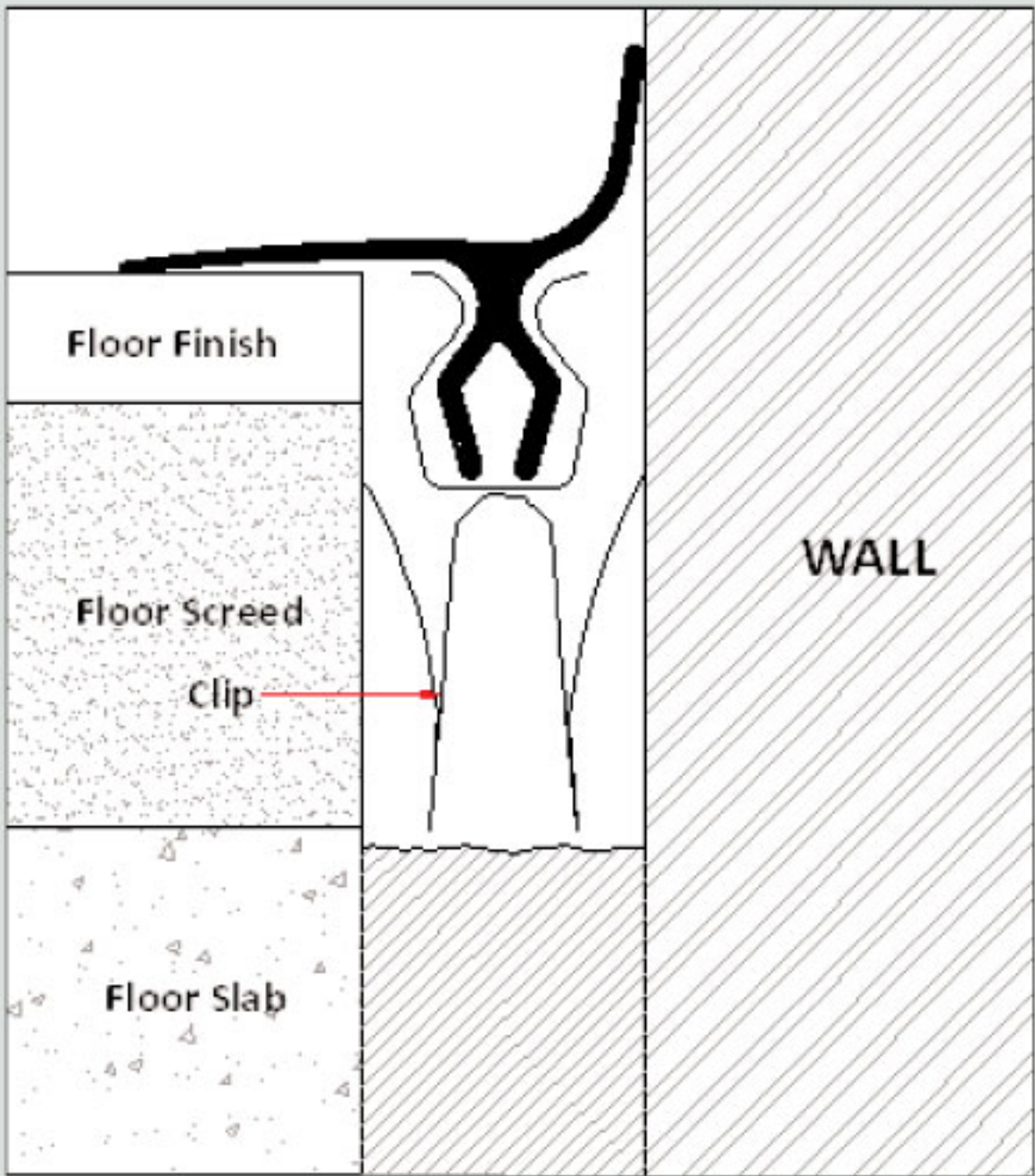

TYPICAL CORNER JOINT

INSTALLATION

Joint faces must be sound, level and smooth, and should be made good if necessary. Clear depths of 20mm for the “tongue” and 70mm for the clips are required in the joint. Snap-fix clips onto SpEC Coverjoint “tongue”, spacing evenly. End clips must be positioned within 50mm of the end of each length. Push the assembly firmly into position, making sure of proper contact at sides and ends.

SpEC Coverjoint can be cut with a normal metal saw to the required lengths on site. Careful angle cutting is also possible for changes of direction. A fine file may be used to smoothen any rough edges after cutting.

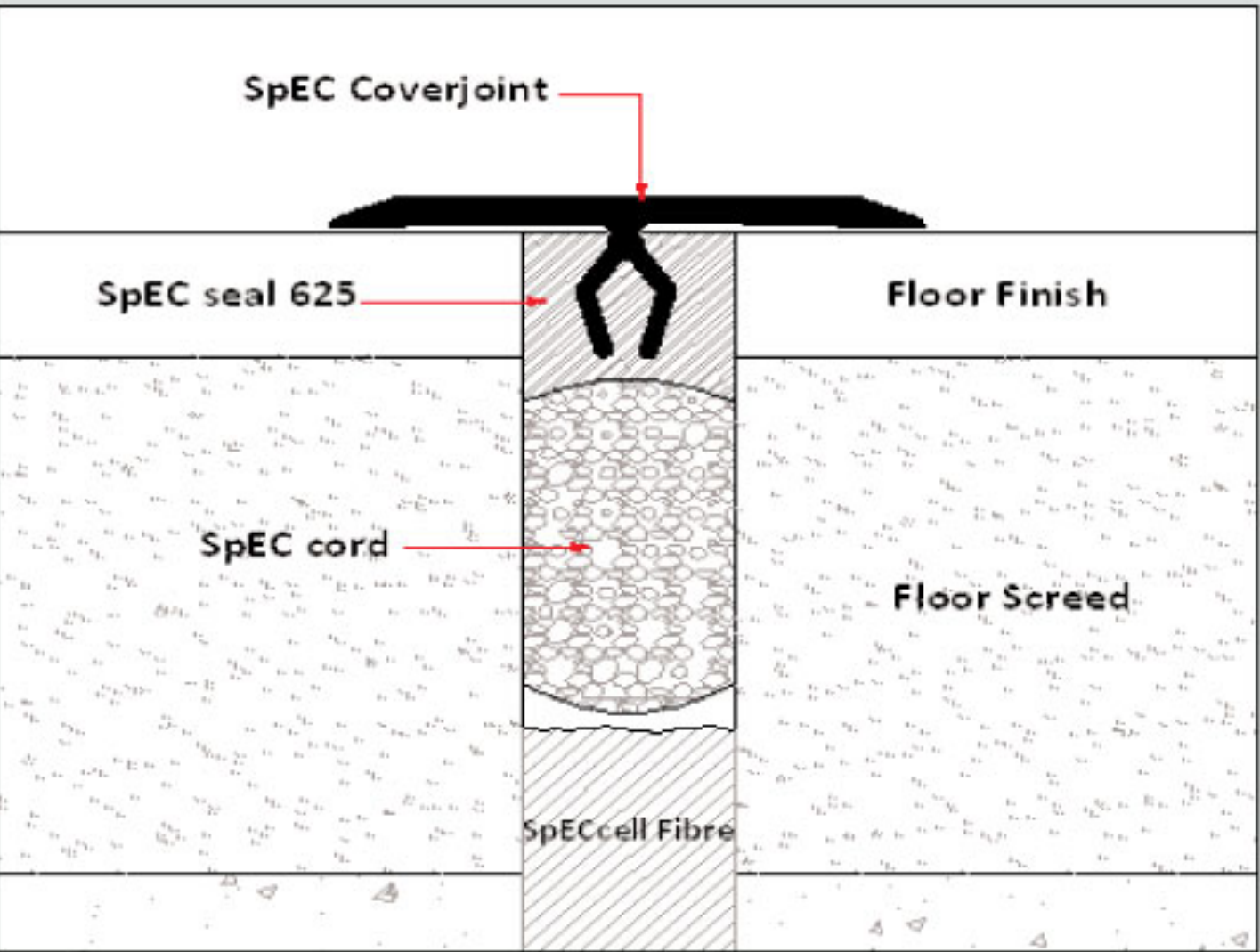

TYPICAL WATER PROOF FLOOR JOINT

Water & Weatherproof Joints:

- Waterproof Floor Joint** (for C5 and C7 profiles): After preparation seal the joint with **SpECseal 625**, pouring grade, and immediately push the SpEC Coverjoint section (without clips) into fresh sealant. Protect for 48 hours before allowing light traffice. Full cure will require upto 7 days.
- Weatherproofing** (all profiles): Apply to bead of neutral curing silicone sealant or a strip of foam sealant tape under the wing of the section on both sides and at ends (butt joints). Fix into position and do not disturb until sealant cures.

Wide Joint (WJ) Profiles

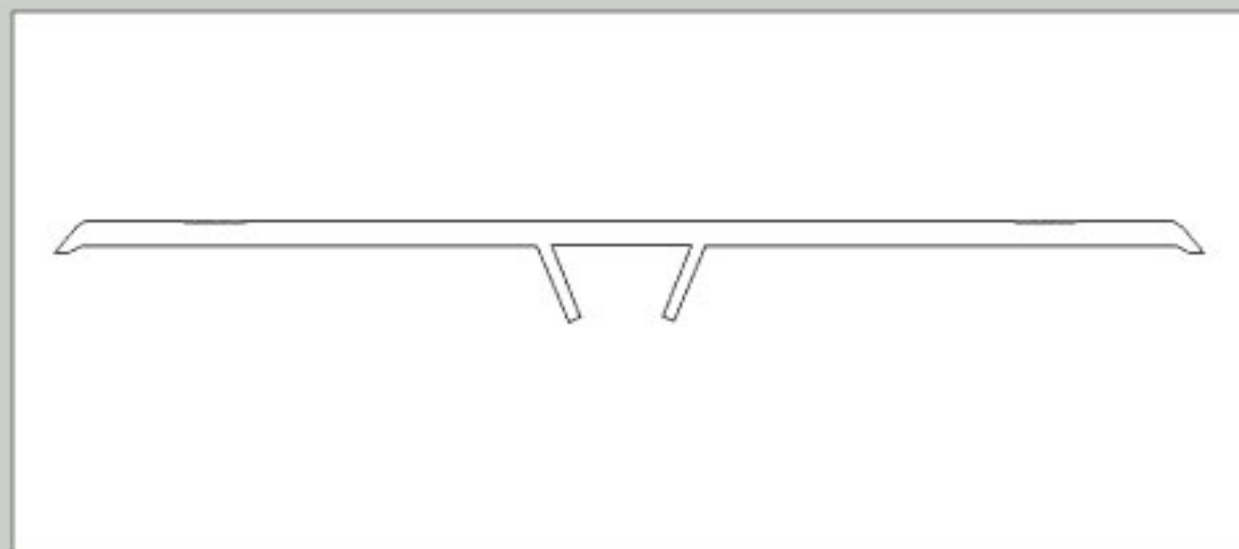

C90/C120 WJ for Straight Joints

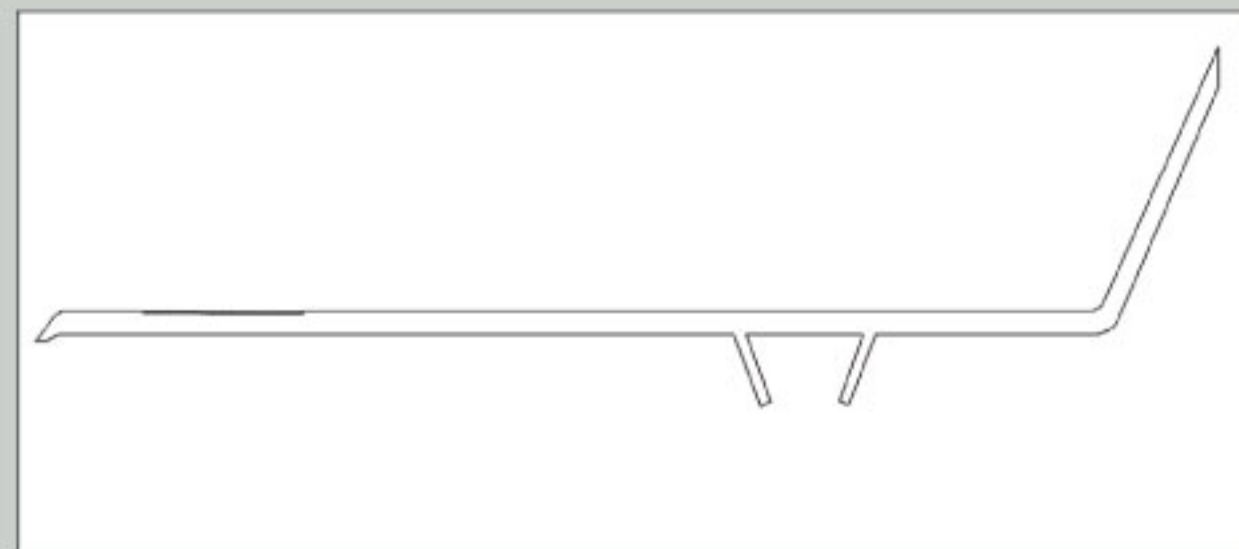

C90/C120 CR for Corner Joints



S^PEC

SPECIALTY ENGINEERING CHEMICALS

PO Box 61347, Dubai, United Arab Emirates. Telephone: +971 4 883 6662, Fax: +971 4 883 7696

E-mail: info@spec.ae www.spec.ws

A BARDAWIL INTERNATIONAL COMPANY

Distributed by:



EMIRATES SPECIALITIES CO. L.L.C.
CONSTRUCTION MATERIAL SUPPLIERS

P.O. Box 3880, Dubai, United Arab Emirates.

Al-Quoz Distribution Centre.

Tel: +971 4 3470767, Fax: +971 4 3470765

E-mail: dubai@esco.ae

P.O. Box 46564, Abu Dhabi, United Arab Emirates.

Tel: +971 2 6784800, Fax: +971 2 6778366

Email: abudhabi@esco.ae

P.O. Box 6156, Sharjah, United Arab Emirates

Tel: +971 6 5420220, Fax: +971 6 5421211

E-mail: sharjah@esco.ae